

THANK YOU FOR CHOOSING OUR QUALITY PRODUCTS.

In order to enjoy the mannequin for a long time, please pay attention to our care and handling recommendations.

WHAT'S IN THE BOX:

- a upper body part
- b legs
- c arms with hook fitting
- d hands with L-Pin system
- e protection gloves
- f hex key

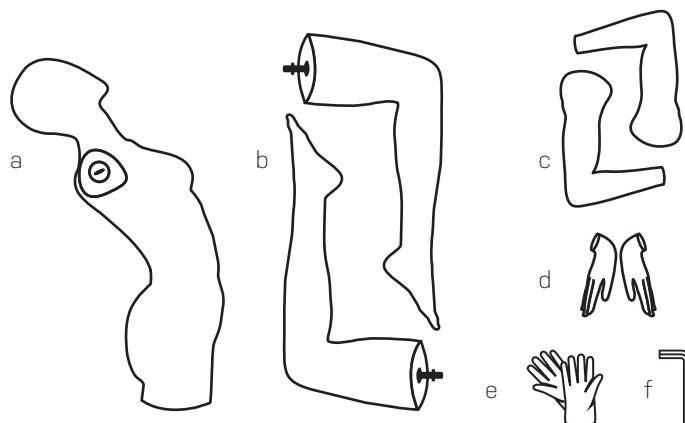

ASSEMBLING INSTRUCTIONS:

STEP 1: Safety

Please take off all jewellery and put on gloves.

STEP 2: Opening the box

Use a box cutter / scissors to cut the straps, box and protective foam bags.

STEP 3: Install the legs

3a Place the torso face down on a flat soft surface and attach the legs to the torso by pushing them in at an angle, then turn into position.

3b Position the mannequin in it's upright position.

Tip: This is a good time to dress the mannequin.

STEP 4: Install hands to arms

Connect the hands inserting them and turning until they reach their final position.

STEP 5: Install arms to body

Connect the arms onto the torso.

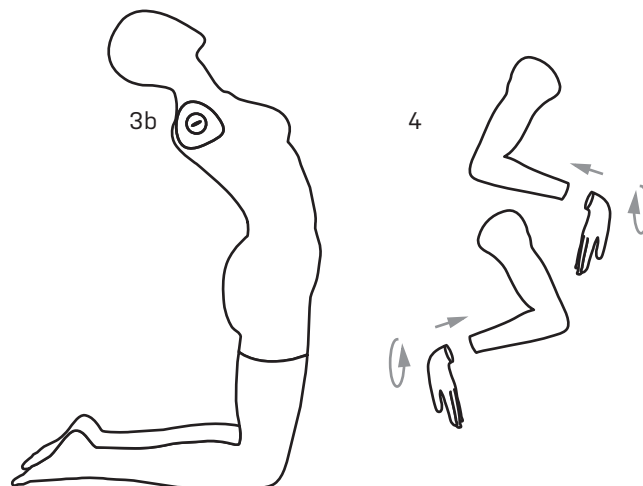
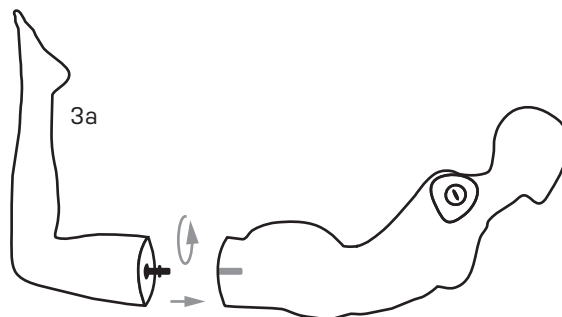

HANDLING & CARE GUIDELINES:

We highly recommend you to mark each part of the mannequin, base and connectors in a non-visible area like the connection ports of the torso, legs, arms and hands to keep all the components together in case of future disassembly or reassembly.

While dressing, one often inserts the arms through the neck opening of the garment. Please ensure that the hook-fitting is opposite from the chest and rotate the arm only when the position of the hook is in front of the insert in the body. This way you avoid damaging the paint on the mannequin.

In order to clean the mannequin, use a slightly moistened cloth with detergent that has been diluted with water. Minor stains can be removed with an eraser.

