

## THANK YOU FOR CHOOSING OUR QUALITY PRODUCTS

In order to enjoy your mannequin for a long time, please pay attention to our care and handling recommendations.

### WHAT'S IN THE BOX:

- 1 a. three screws pin assembly  
b. assembly mask for connector
- 2 a. calf pin  
b. thigh pin
- 3 base plate with three screw holes
- 4 hand accessories pin\*
- 5 a. small hex key  
b. big hex key
- 6 protection gloves
- 7 head
- 8 upper body part
- 8 arms
- 10 hands
- 11 lower body part
- 12 leg with spring technology\*\*

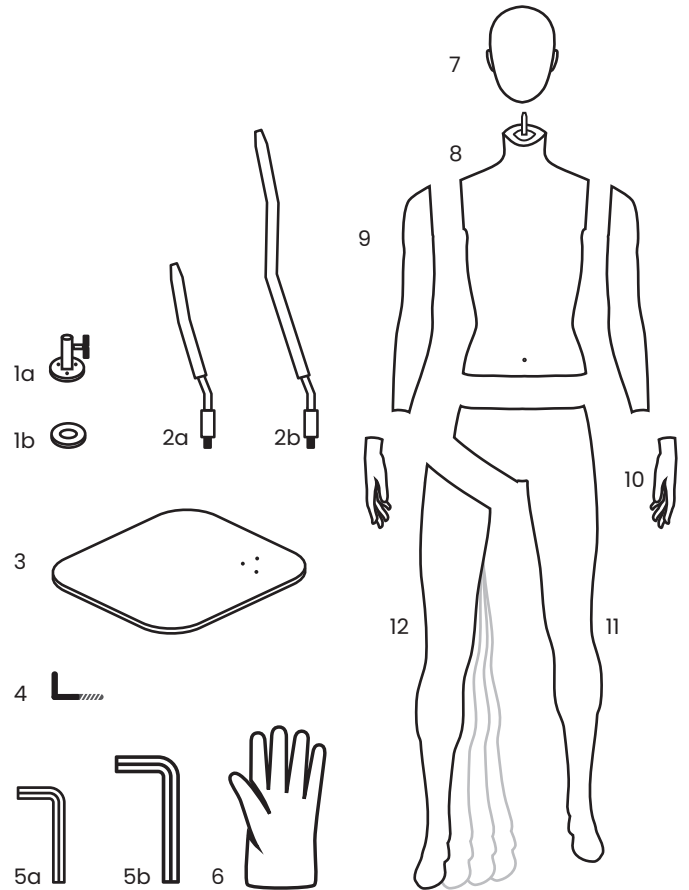

\*hand accessory pin is pre-installed if possible for pose

\*\*spring leg: Display mannequins with wider leg position are equipped with a spring leg fitting. When putting on trousers, you can simply pull the legs closer without needing to disassemble the separate leg.

### ASSEMBLING INSTRUCTIONS:

#### STEP 1: Safety

Please take off all jewellery and put on gloves.

#### STEP 2: Opening the box

Use a box cutter / scissors to cut the straps, box and protective foam bags.

**ATTENTION!** Don't cut too deep to avoid damage on any of the product components. Take all the parts out of the box one by one and place them on a soft surface.

#### STEP 3: Install the base

3a: Screw the calf pin connector to the base plate.

Tip: Make sure to tighten the screws very well.

3b: Put the assembly mask over the pin connector.

3c: Place the calf pin in the connector and tighten.

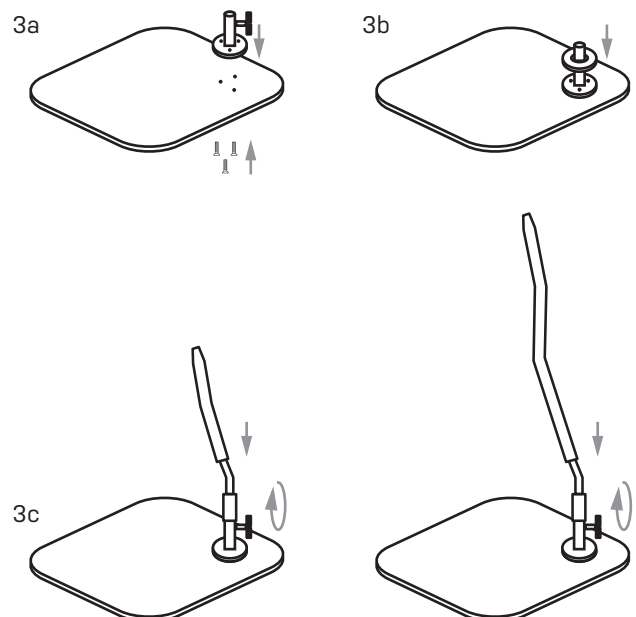

continues on the other side →

← starts on the other side

**STEP 4: Install the leg**

4a. Place the lower body part feet up on a soft surface, now you can easily connect the separate leg onto the hip part by rotating it a quarter turn until it clicks.

*Tip: This is the perfect position to dress trousers and put shoes on.*

4b. Turn the legs again and position the legs on the base. Ensure that the base is stable and on a flat surface to avoid problems. Once the legs are positioned onto the base, please tighten the hand screw of the calf pin connector to keep the legs in place onto the base.

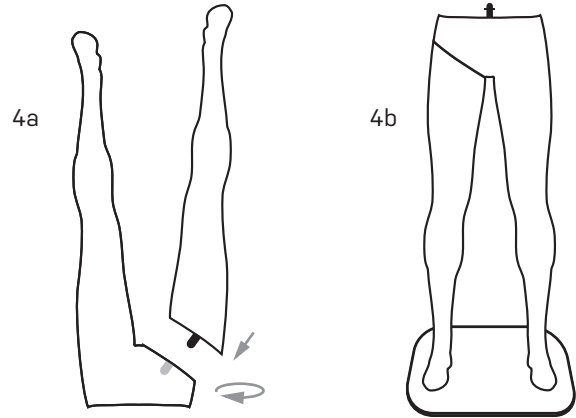

**STEP 5: Install the torso and head**

5a. Place the torso on the hip part, slightly twisted and rotate the torso into its final position.

*Tip: This is a good time to dress the torso.*

5b. Install the head by simply pushing it in.

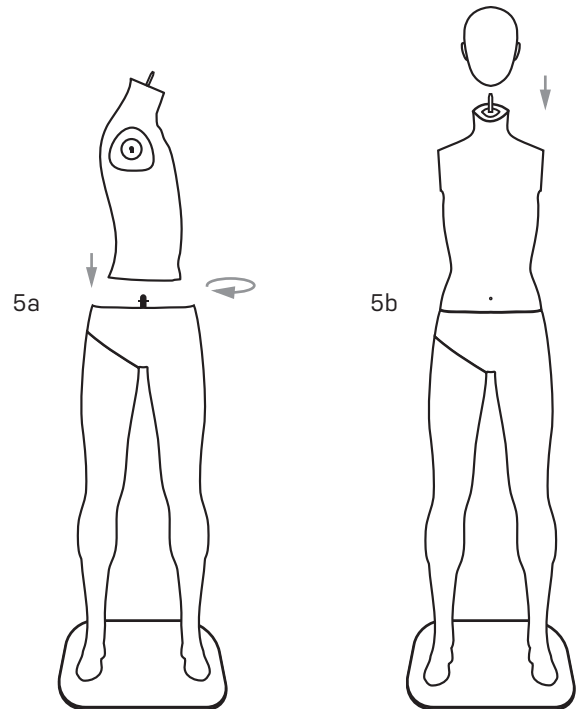

**STEP 6: Install arms & hands**

6a. Connect the arms onto the torso. Once the arms are connected, they can be rotated front and back to find that perfect position.

*Tip: If the arm should not go down to its locked position simply try to rotate the arm front/back until the arm falls into his lock position.*

6b. Install now the hands entering the pin and rotate to its final position.

*Tip: Only connect the hands once the mannequin is fully dressed.*

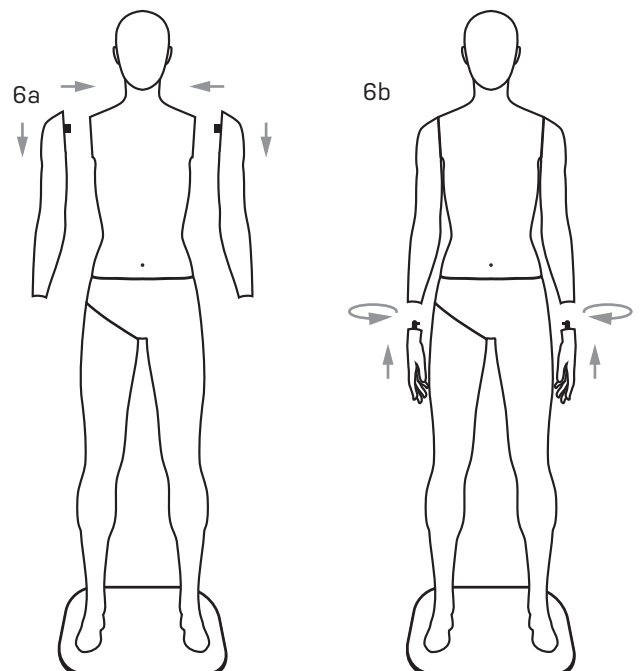

**HANDLING & CARE GUIDELINES:**

We recommend to (dis)assemble the mannequin on a soft and flat surface to avoid any damage.

Please always remove any jewellery before handling a mannequin to avoid scratches. We recommend using the provided gloves to avoid marks and stains.

While dressing, one often inserts the arms through the neck opening of the garment. Please ensure that the hook is opposite from the chest and rotate the arm only when the position of the hook is in front of the insert in the body. This way you avoid damaging the paint on the mannequin with the hook.

In order to clean the mannequin, please use a slightly moistened cloth with detergent that has been diluted with water. Minor stains can be removed with an eraser.