

THANK YOU FOR CHOOSING OUR QUALITY PRODUCTS

In order to enjoy your mannequin for a long time, please pay attention to our care and handling recommendations.

This display mannequin is responsibly produced using sustainable Bio Resin composed of sustainable Susterra®* and supported by natural fibres. Together we contribute to a greener future.

WHAT'S IN THE BOX:

1. base
2. foot pin
3. calf pin and connector
4. footpin tightening tool
5. hex keys*
6. hand accessory pin**
7. touch-up paint
8. gloves
9. upper body part
10. arms
11. hands
12. lower body part
13. leg with spring***

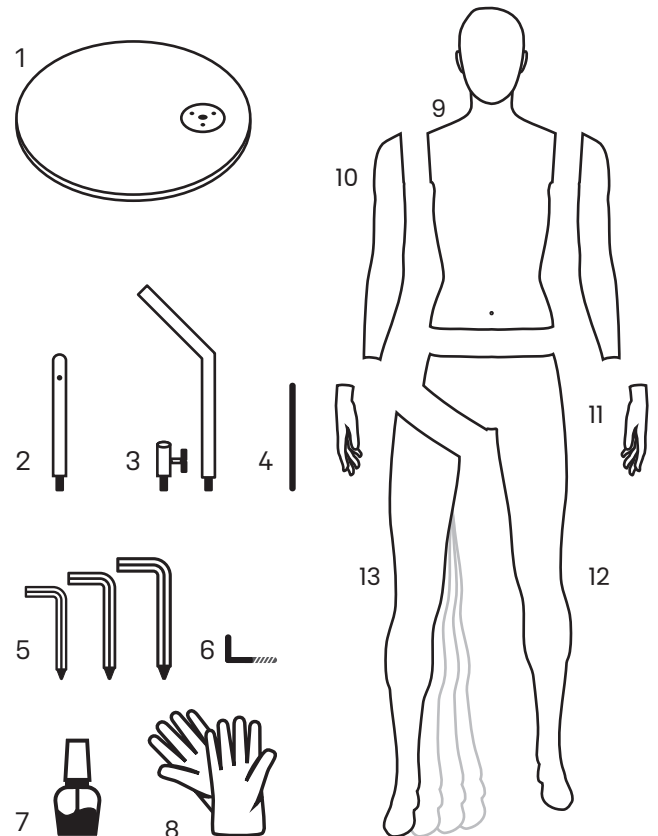

*The hex key is offered in order to adjust the tension of the arm fitting if required. If you like to loosen the tension, please move the hex key anticlockwise. We recommend you to start with a quarter turn per try. Next please take out the hex key and now rotate the balconet part also anticlockwise. Test the result by applying the arm. If not enough, please follow this procedure one more time. If you consider the arm-torso connection is too loose, please follow above procedure in opposite ways so rotate the hex key clockwise instead.

**Hand accessory pin is pre-installed if possible for pose.

***Display mannequins with wider leg position are equipped with a spring leg fitting. When putting on trousers, you can simply pull the legs closer without needing to disassemble the separate leg.

ASSEMBLING INSTRUCTIONS:

STEP 1: Safety

Please take off all jewellery and put on gloves.

STEP 2: Opening the box

Use a box cutter / scissors to cut the straps, box and protective foam bags.

ATTENTION: Don't cut too deep to avoid damage on any of the mannequin components. Take all the parts out of the box one by one and place them on a soft surface.

STEP 3: Install the base on the floor

3a: Screw the foot pin clockwise into the base plate. Use the tool included to tighten more.

3b: Screw the calf pin connector clockwise into the base and tighten well. Please install the calf pin in the connector with top of calf pin in the centre of the base. Place the calf pin in the connector and tighten.

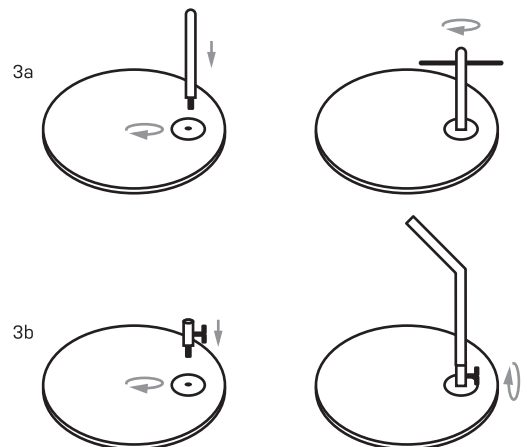

← begins on the other side

STEP 4: Install the leg

4a: Place the lower body part feet up on a soft surface, now you can easily connect the separate leg onto the hip part by rotating it a quarter turn.

Tip: this is the perfect position to dress trousers and put shoes on.

4b: Position the legs on the base either with foot pin or calf pin. If you are installing the calf pin, make sure to tighten the wing screw in the back of leg. Ensure that the base is stable and on a flat surface to avoid any stability problems.

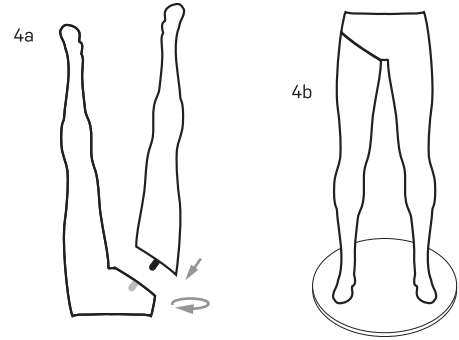

STEP 5: Install the torso

5a: Place the torso on the hip part, slightly twisted and rotate the torso into its final position. Tip: This is a good time to dress the torso.

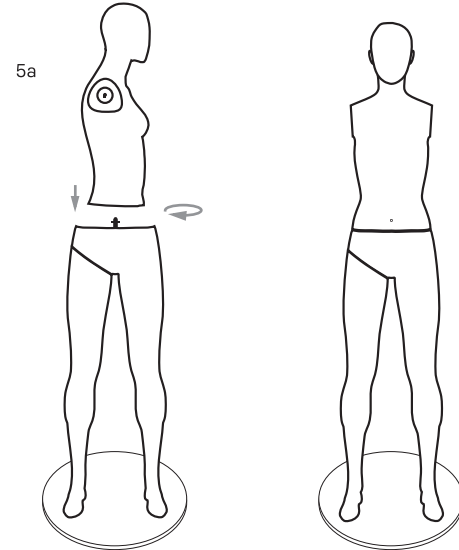

STEP 6: Install arms & hands

6a: Connect the arms onto the torso. Once the arms are connected, they can be rotated front and back to find that perfect position.

Tip: If the arm should not go down to its locked position simply try to rotate the arm front/back until the arm falls into his lock position.

6b: Install now the hands entering the pin and rotate to its final position.

Tip: Only connect the hands once the mannequin is completely dressed.

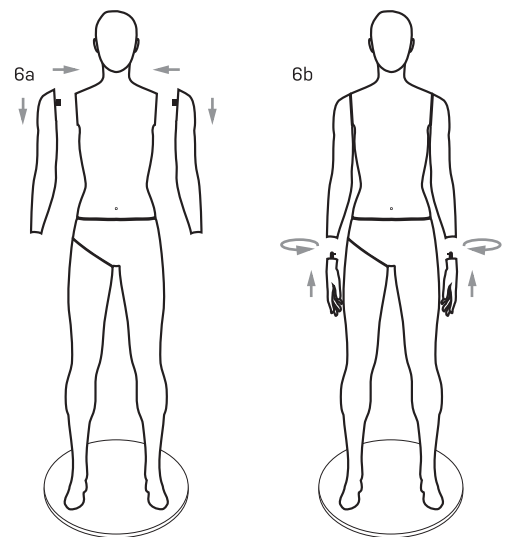

HANDLING & CARE GUIDELINES:

We recommend you to (dis)assemble the mannequin on a soft and flat surface to avoid any damage.

Please always remove any jewellery before handling a mannequin to avoid scratches. We advise using the provided gloves to avoid marks and stains.

While dressing, one often inserts the arms through the neck opening of the garment. Please ensure that the ball-fitting is opposite from the chest and rotate the arm only when the position of the ball is in front of the insert in the body. This way you avoid damaging the surface of the mannequin.

In order to clean the mannequin, please use a slightly moistened cloth with detergent that has been diluted with water. Minor stains can be removed with an eraser.

We highly recommend you to mark each part of the mannequin, base and connectors in a non-visible area like the connection ports of the torso, legs, arms and hands to keep all the components together in case of future disassembly or reassembly.